



HWH 2K, 3t



HWH KS, 5t

### HWH 2K PROLINE Hydraulic car jack

- with 2 pistons

### HWH 2KS PROLINE

- with 2 pistons and spindle

### HWH KS PROLINE

- with piston and spindle

**Capacity 2 - 30 t**

For lifting vehicles on one side (the lifted load must be secured mechanically with supporting stands, for example).

#### Features

- Versions with hydraulic piston and mechanical spindle drive resp. with two hydraulic pistons.
- With carrying bracket from load capacity 20 t.
- Extremely low design with model HWH 2K/D (incl. one pressure section for lift extension).
- With integrated pressure control valve for a longer service life of the jack.
- Integrated seat valve for controlled lowering of the load.



HWH 2K NB, 10t



HWH 2KS, 10t



HWH KS, 20t

**Technical data HWH 2K PROLINE and HWH 2KS PROLINE**

Model	Art.-No.	Capacity t	Weight kg
HWH 2K 3,0	32301016	3	4.87
HWH 2K 5,0	32304001	5	6.3
HWH 2KS 10,0	32304002	10	8.8
HWH 2KS 12,0	32307014	12	11.0
HWH 2K NB 10,0 <sup>1</sup>	32306034	10	7.9
HWH 2K/D 10,0 <sup>2</sup>	32304003	10	6.5

<sup>1</sup>horizontal pump unit    <sup>2</sup>with replaceable pressure section (height 45 mm)

**Dimensions HWH 2K PROLINE and HWH 2KS PROLINE**

Model	HWH 2K 3,0	HWH 2K 5,0	HWH 2KS 10,0	HWH 2KS 12,0	HWH 2K NB 10,0 <sup>1</sup>	HWH 2K/D 10,0 <sup>2</sup>
a, mm	107	98	129	185	∅	140
b, mm	90	120	164	185	127	164
c, mm	124	134	160	176	197	160
H min., mm	185	215	200	230	175	120
H max., mm	400	520	530	570	385	230
h1, mm	110	145	130	130	104	54
h2, mm	105	160	132	125	106	56
hTr, mm	-	-	68	85	-	-
∅ k, mm	60 x 35	43	40	48	43	38
l, mm	115	134	116	53	136	112
m, mm	80	90	116	133	116	116
Tr, mm	-	-	32 x 5	40 x 6	-	-
∅ z1, mm	32	39	52.58	61.5	52.5	52.5
∅ z2, mm	23	29	39.5	48.5	39.5	39.5

<sup>1</sup>horizontal pump unit    <sup>2</sup>with replaceable pressure section (height 45 mm)

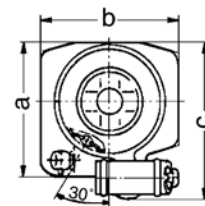
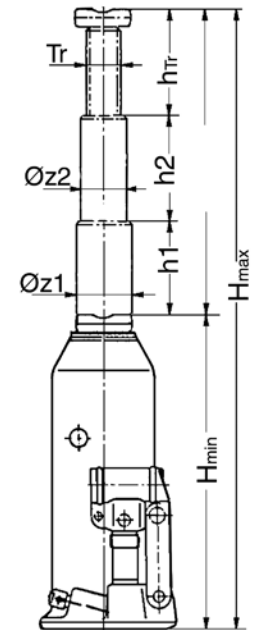
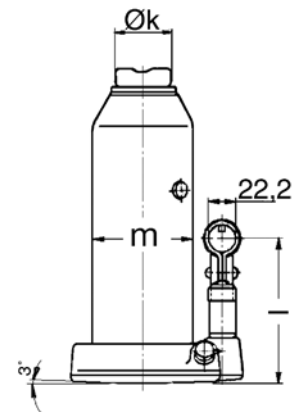

**Technical data HWH KS PROLINE with piston and spindle**

Model	Art.-No.	Capacity t	Weight kg
HWH KS 2,0	32300002	2	2.9
HWH KS 3,5	32302004	3.5	2.9
HWH KS 5,0	32303000	5	3.9
HWH KS 8,0	32305003	8	5.7
HWH KS 10,0	32306026	10	5.7
HWH KS 12,0	32307006	12	7.1
HWH KS 15,0	32308002	15	8.3
HWH KS 20,0	32309009	20	10.7
HWH KS 25,0	32310007	25	13.1
HWH KS 30,0	32311003	30	14.5

**INFO**

HWH KS PROLINE with capacity of 50t and 100t available on request.

**Dimensions HWH KS PROLINE with piston and spindle**

Model	HWH KS 2,0	HWH KS 3,5	HWH KS 5,0	HWH KS 8,0	HWH KS 10,0	HWH KS 12,0	HWH KS 15,0	HWH KS 20,0	HWH KS 25,0	HWH KS 30,0
a, mm	34	34	38	105	105	116	121	110	122	122
b, mm	105	105	110	122	122	120	130	164	185	185
c, mm	103	103	110	124	124	134	139.5	160	176	176
H min., mm	170	170	212	220	220	230	230	240	240	240
H max., mm	377	377	462	480	480	497	495	505	515	482
h1, mm	115	115	150	150	150	157	155	155	157	142
hTr, mm	92	92	100	110	110	110	110	110	118	100
∅ k, mm	28	28	40	48	48	48	60	60	65	65
l, mm	116	113	113	116	116	116	116	116	120	116
m, mm	58	58	65	80	80	90	95	116	133	133
Tr, mm	20 x 4	20 x 4	24 x 5	32 x 5	32 x 5	35 x 6	40 x 6	45 x 6	48 x 6.35	48 x 6.35
∅ z1, mm	24.9	24.9	29.9	39.5	39.5	43.5	48.5	54.5	59.5	61.5



## JH Universal jacks

### Capacity 2 - 50 t

Universal jacks supply high forces for general operations like lifting, pushing, moving, supporting of all kind of loads.

#### Features

- Robust, long life design.
- Pressure relief valve
- Precise controlled lowering.
- Additional screw extension of the piston (up to 20 t).
- Grooved saddle.
- Large base plates for increased stability.
- JH-50-2 with two-stage pump.
- Incl. operating lever.



JH-50-2

### Technical data JH

Model	Art.-No.	Capacity t	Stroke mm	Additional screw extension mm	Closed height mm	Base plate mm	Pump	Weight kg
JH-2 B	N13300003	2	115	50	181	90 x 95	single-stage	2.7
JH-4 B	N13300004	4	126	60	205	115 x 110	single-stage	3.7
JH-6 B	N13300005	6	130	75	219	115 x 110	single-stage	4.7
JH-8 B	N13300006	8	152	70	225	120 x 120	single-stage	5.7
JH-12 B	N13300007	12	153	80	240	140 x 130	single-stage	8.0
JH-20 B	N13300008	20	153	80	240	160 x 155	single-stage	11.0
JH-30	N13300408	30	180	–	280	210 x 180	single-stage	22.0
JH-50-2	N13300893	50	178	–	305	255 x 190	two-stage	53.0

# MH Machine jack

## Capacity 5 - 25t

For lifting heavy machinery and other loads.

### Features

- Can be used in every position.
- Lifting by means of a hand pump.
- Lowering by means of a precision lowering valve.
- With carrying handle for MH 50 and MH 100.
- With carriage for MH 250.
- Pressure control valve for a longer service life of the jack.
- Integrated lifting limitation.
- Low application height of the claw.
- Slewing claw (MH 50 and MH 100)
- Large base plate for a high level of stability.
- Stable construction with hard-chromium plated piston rod.



### Technical data MH

Model	Art.-No.	Capacity t	Stroke mm	Application height min. with claw mm	Application height min. with head mm	Pump lever force with full load daN	Weight kg
MH 50	40014771	5	205	25	≤ 368	38	25
MH 100	40014772	10	230	30	≤ 420	40	35
MH 250	40014773	25	215	58	≤ 505	40	109

### Dimensions MH

Model	MH 50	MH 100	MH 250
A, mm	393	449	-
B, mm	320	325	459
C, mm	213	205	420
D, mm	115	120	220
E, mm	53	55	90
G, mm	25	30	58
H, mm	368	420	505
H1, mm	573	650	720
H2, mm	205	230	215
J, mm	77	74,5	142,5
K, mm	93	108	175
L, mm	520	520	920/840
M, mm	740	745	1305/1225
N, mm	140	170	210/283
Ø Z, mm	76	91	155

